

# ATTENTION

## UMass Amherst Graduate Students

EFFECTIVE 8/1/2021

The Pharmacy Benefit Manager (PBM) through Wellfleet RX/KPP is changing to WellfleetRX/ESI. Because of this change, All students who will be continuing with the UMass Student Health Benefit Plan after 8/1/2021, will need to print a new ID card. Please note there will be no change in benefits. Below are sample id cards and the changes that will be made:

### ID cards through 7/31/2021

<b>Contact Information</b>	
<b>Eligibility/Claims: (877) 657-5027</b>	
*Travel Assistance Services Only: Inside US/Canada: (877) 305-1966 International Call: (715) 295-9311	
For care coordination, we recommend you seek care from your student health center, if available.	
<b>AWAY FROM HOME CARE</b>	
Pre-certification required-call Wellfleet: (877) 657-5027 Pre-certification does not guarantee coverage or payment	
<b>Benefits are not insured by Cigna or affiliates. Forward all claims to:</b>	
Cigna PPO PO Box 188061 Chattanooga, TN 37422-8061 EDI Payer ID: 62308 Cigna Providers: cigna.com or wellfleetstudent.com	Correspondence/Non PPO: Wellfleet Group, LLC PO Box 15369 Springfield, MA 01115-5369 EDI Payer ID: 87843 wellfleetstudent.com
Self-funded	
Possession of card does not guarantee coverage	

 	
<b>MEMBER</b>	
ID Card SAMPLE1 ID: 001721126 000 *S* ST0941SH - UMass Amherst - Graduate	
<b>BENEFITS</b>	
Rx Copay: Tier 1: \$10, Tier 2: \$10, Tier 3: \$10 WellfleetKPP - RxGroup: KU040, RXBIN: 012882, PIN: KPP Pharmacist Help Desk: (888) 263-7884 OV Copay: \$10 In-Network, Deductible waived ER Copay: \$100 Deductible waived	
Eligibility/Claims: (877) 657-5027 **No Referral Required**	
Davis Vision Affinity Disc Plan 2290 davisvision.com (800) 999-5431 See Reverse Side For Important Information	

### Effective 8/1/2021

<b>Contact Information</b>	
<b>Eligibility/Claims: (877) 657-5027</b>	
*Travel Assistance Services Only: Inside US/Canada: (877) 305-1966 International Call: (715) 295-9311	
For care coordination, we recommend you seek care from your student health center, if available.	
<b>AWAY FROM HOME CARE</b>	
Pre-certification required-call Wellfleet: (877) 657-5027 Pre-certification does not guarantee coverage or payment	
<b>Benefits are not insured by Cigna or affiliates. Forward all claims to:</b>	
Cigna PPO PO Box 188061 Chattanooga, TN 37422-8061 EDI Payer ID: 62308 Cigna Providers: cigna.com or wellfleetstudent.com	Correspondence/Non PPO: Wellfleet Group, LLC PO Box 15369 Springfield, MA 01115-5369 EDI Payer ID: 87843 wellfleetstudent.com
Wellfleet Group, LLC	
Possession of card does not guarantee coverage	

 	
<b>MEMBER</b>	
TEST IDCARD ID: 001908621 000 *S* ST0941SH - UMass Amherst - Graduate	
<b>BENEFITS</b>	
Wellfleet Rx/ESI - Rx Copay: Tier 1: \$10, Tier 2: \$10, Tier 3: \$10 DV Copay: \$10 In-Network, Deductible waived ER Copay: \$100 Deductible waived RxGroup: WFLEET1 Pharmacist Rx Help Desk: (800) 922-1557 RX BIN: 003858 PCN: A4 Member Pharmacy Help Desk: (877) 640-7940	
Eligibility/Claims: (877) 657-5027 **No Referral Required**	
Davis Vision Affinity Disc Plan 2290 davisvision.com (800) 999-5431 See Reverse Side For Important Information	

To obtain your health insurance ID card, please follow the instructions below:

- Visit [www.wellfleetstudent.com](http://www.wellfleetstudent.com) and enter your school name into the search box.
- From your school's landing page, click the menu icon in the top right corner and select "My Account" to access your account.
- If you don't have an account on our system, click "Create a New Account" on the student sign in page.
  - Please use the email address where you received this message when creating your account.
  - If you already have an account, enter your email address and password to log in.
  - To access your online ID card, click on the "Student Options" tab.
  - To view your claims history, click on the "Claims" tab
  - To view your benefits brochure, click on the "Benefits" tab

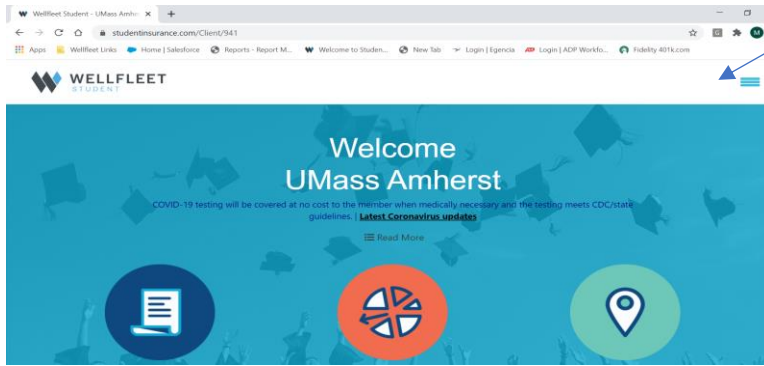

Click on the Menu Icon in top right corner

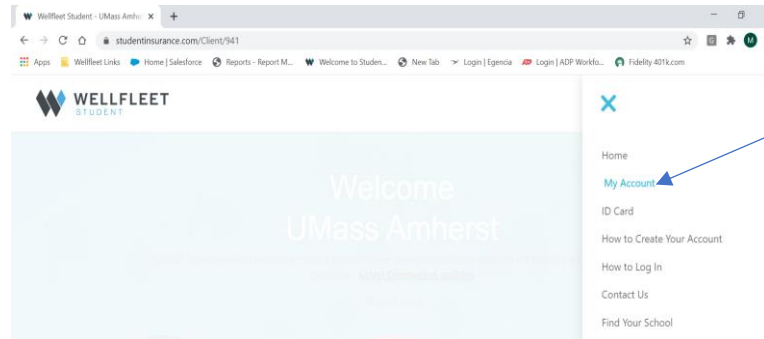

Next select – "My Account"

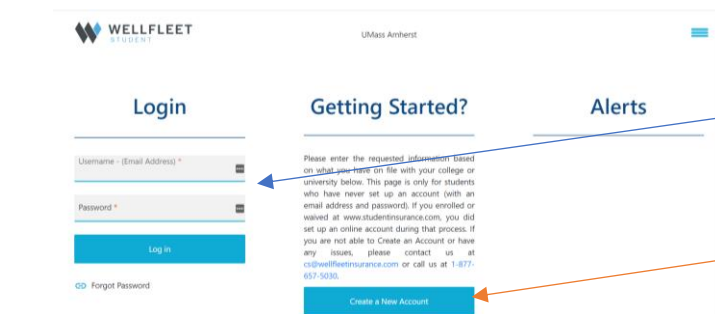

Login to your existing Wellfleet Account  
New Users – must Create a New Account with Wellfleet

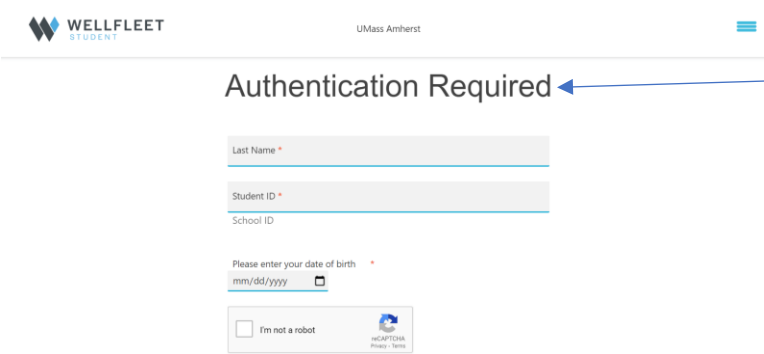

Last Name  
Student ID  
Date of Birth  
I am not a Robot

Once you have created your account under Student Options, Select – Print ID Card(s)

